

PILE SCHEDULE					
PILE No.	PILE LOADING (SERVICE)				COMMENTS
	AXIAL (kN)	SHEAR (kN)	MOMENT (kNm)	CUT-OFF LEV. (m) (NATURAL F.L.)	
1	+120	-15	20	-	22.155
4	-	-	-	-	22.155
5	-	-	-	-	22.155
6	-	-	-	-	22.155
7	-	-	-	-	22.155
8	-	-	-	-	22.155
9	-	-	-	-	22.155
10	-	-	-	-	22.155

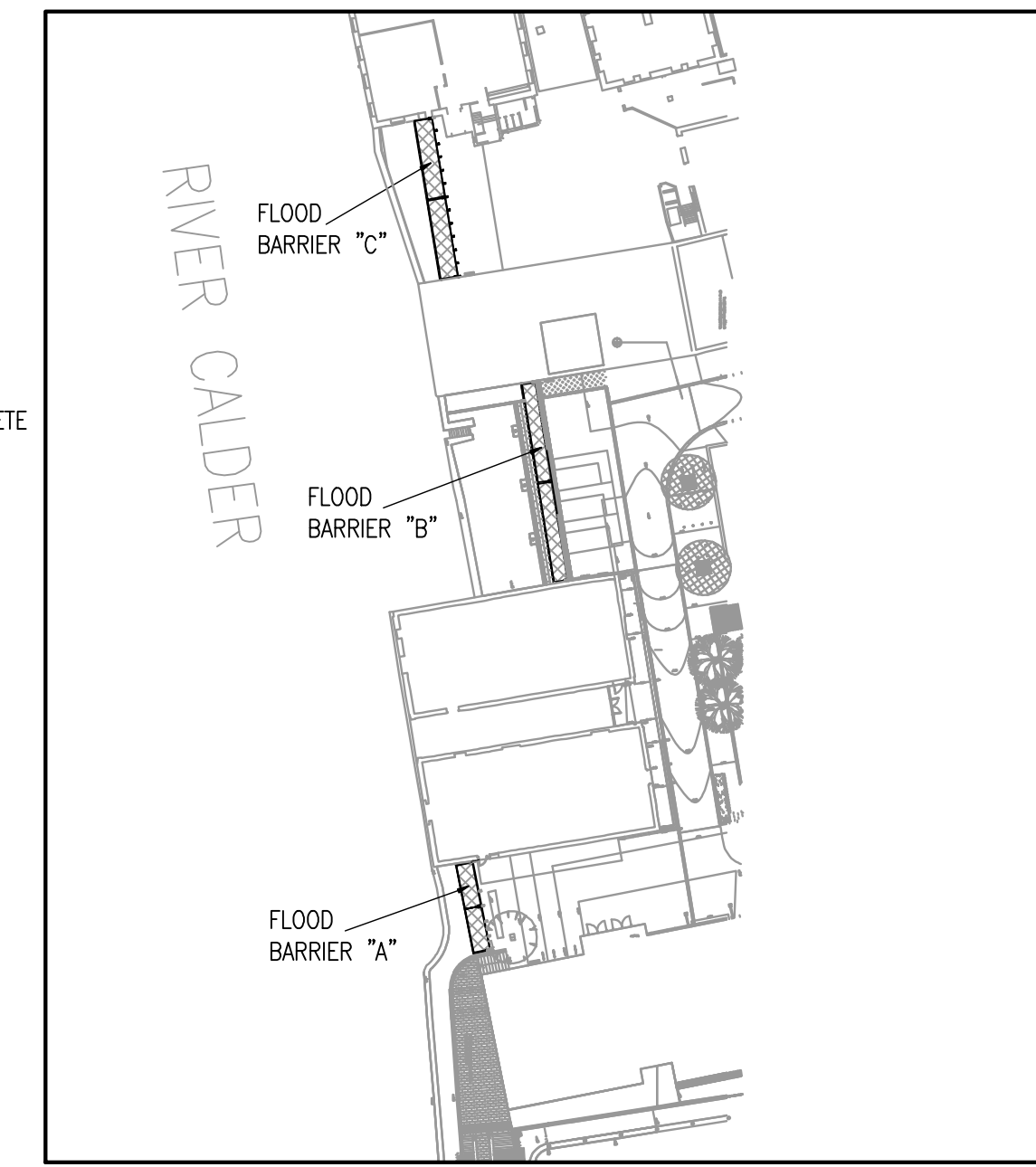

- NOTES.
1. ALL MATERIALS AND WORKMANSHIP TO COMPLY WITH SEJC CONSULTING ENGINEERS STANDARD SPECIFICATION FOR REINFORCED CONCRETE AND ALL RELEVANT BRITISH STANDARDS.
 2. THIS DRAWING TO BE READ IN CONJUNCTION WITH ALL RELEVANT ARCHITECTS AND SEJC CONSULTING ENGINEERS DRAWINGS.
 3. FOR DETAILS OF REINFORCEMENT REFER TO SEJC CONSULTING ENGINEERS DRAWING NUMBER 501180C/20-319 & 320
 4. FOR DETAILS OF CONCRETE MIX REFER TO SEJC STANDARD CONCRETE SPECIFICATION.
 5. ALL CONCRETE TO BE VIBRATED IN ACCORDANCE WITH SEJC CONSULTING ENGINEERS STANDARD SPECIFICATION FOR REINFORCED CONCRETE.
 6. LOCAL SOFT SPOTS TO BE REPORTED TO SEJC CONSULTING ENGINEERS.
 7. BLINDING CONCRETE TO BE C20.

MK	REVISIONS	BY	DATE	CHK
STATUS:-				
AS-BUILT				
DRAWN BY: SH DATE: NOV/07				
CHECKED BY: DATE:				
PROJECT ENGINEER: DATE:				
CLIENT				
CTP & JAMES				
PROJECT				
WAKEFIELD WATERFRONT				
BUILDING 20				
SEJC Consulting Engineers				
Consulting Structural & Civil Engineers				
Sanderson House, Station Road, Horsforth, Leeds LS18 5NT				
Telephone 0113 2590090 Fax 0113 2586640				
TITLE				
FLOOD BARRIER TYPE 'A'				
FOUNDATION & PIT SET OUT				
SCALES				
AS SHOWN				
CONTRACT No				
DRG No				
501180C				
20-013				
A1 - (1:1)				